

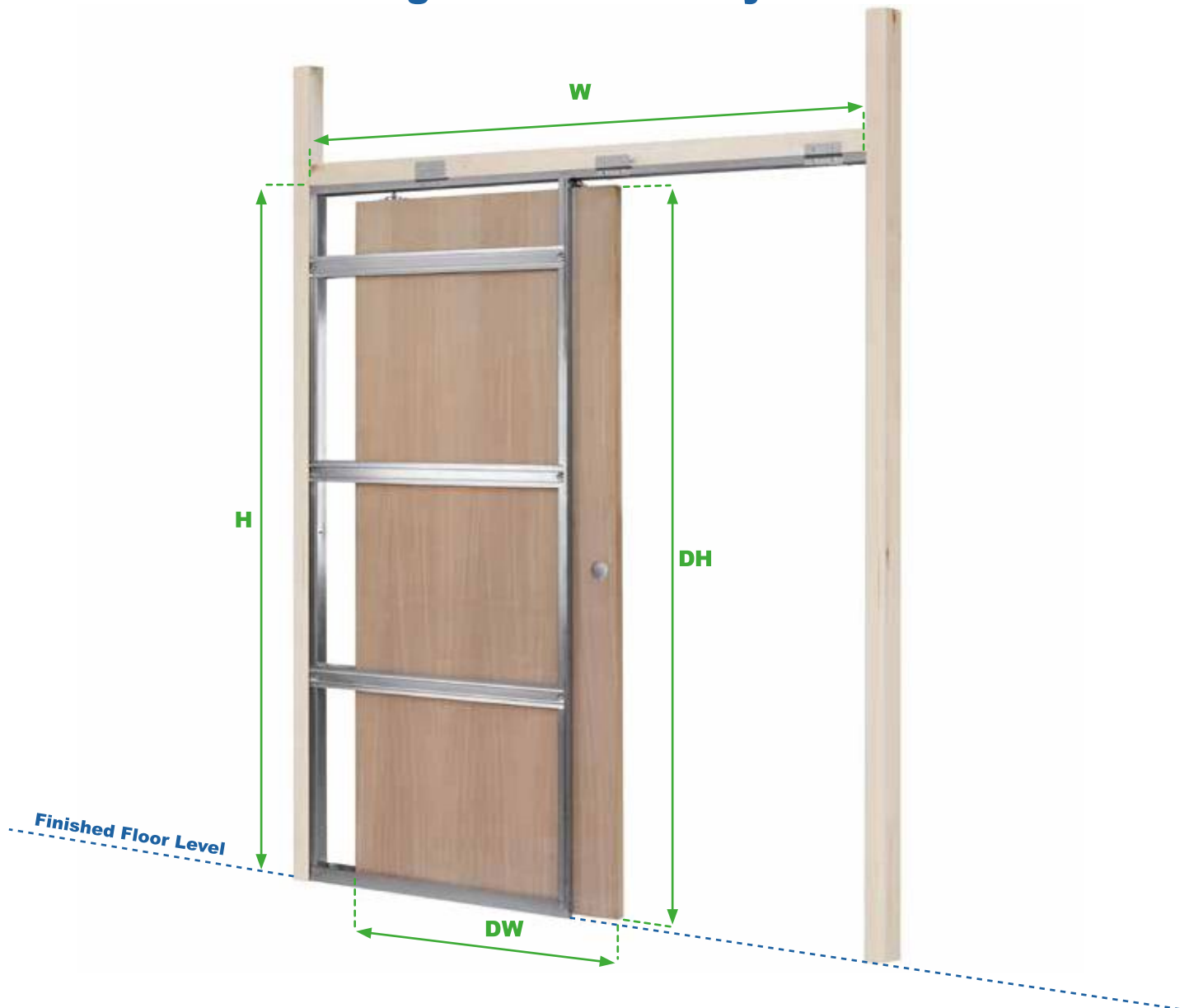

ROCKET POCKET

Sliding Pocket Door Systems



**INSTALL
AT FINISHED FLOOR
LEVEL**

DOOR PANEL		frame width	OVERALL DIMENSIONS	
DW	DH		W	H
686 (27")	1981 (78")	75 (3")	1390	2050
762 (30")	1981 (78")	75 (3")	1545	2050
838 (33")	1981 (78")	75 (3")	1695	2050
726	2040	75 (3")	1470	2110
826	2040	75 (3")	1670	2110
926	2040	75 (3")	1870	2110

Door Th. 35/44 mm



CAUTION

REQUIRED

Please follow the instructions carefully as they have been designed to help you, don't skip any pages or stages as you may cause yourself problems.

Use the correct tools and relevant protective clothing/eyewear, gloves are essential as there may be some sharpe edges.

A pair of trestles would be useful for the assembly.

TOOLS

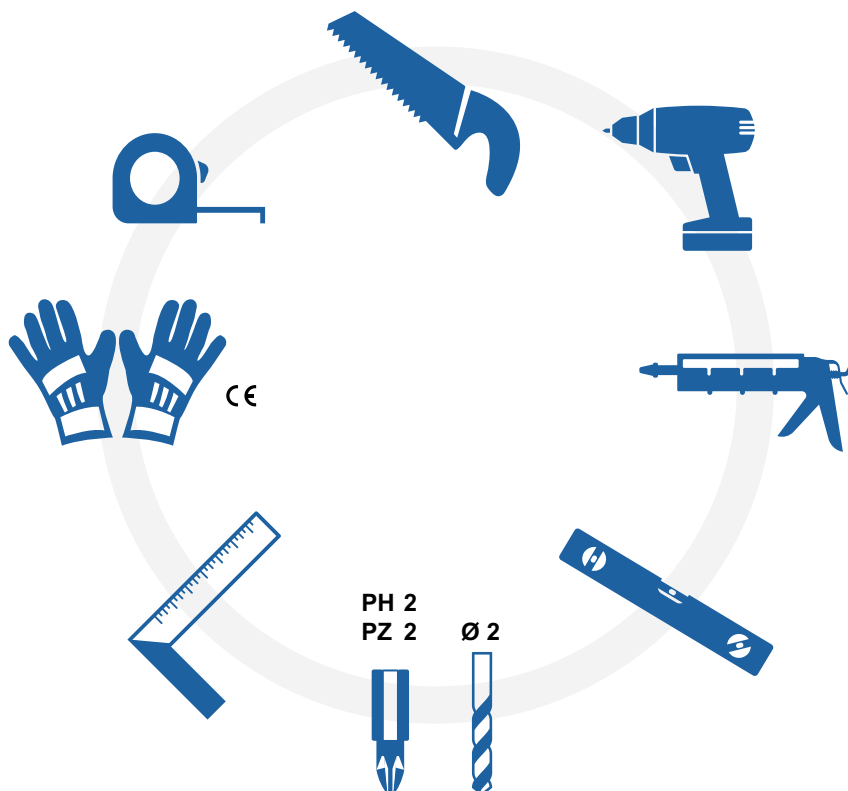

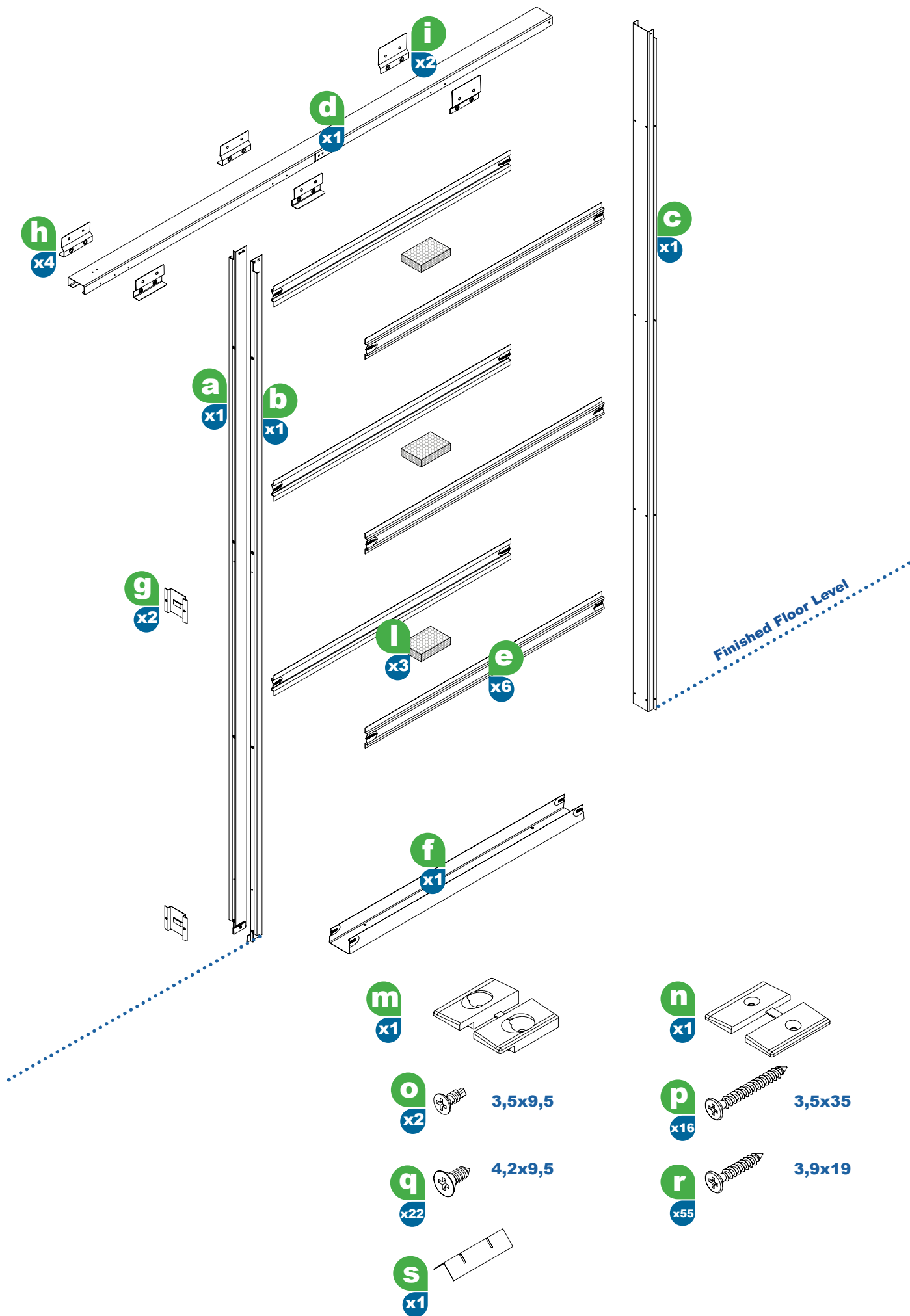

aa
x2



M8

cc
x2



M8

ee
x8

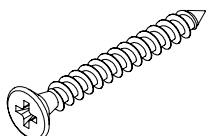

3,5x35

gg
x1

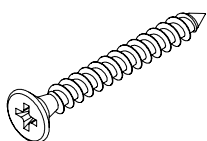

3,5x35

ii
x2

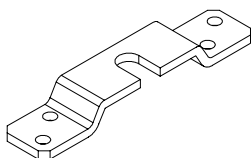

mm
x2

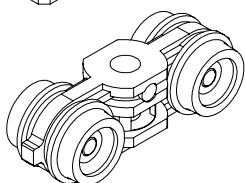

bb
x2

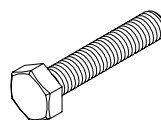

M8x40

dd
x2



3,9x9,5

ff
x1



hh
x1

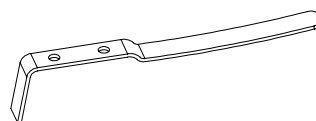

ll
x2

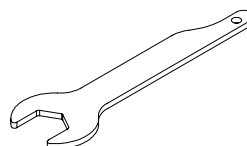

DOOR PANEL	hole in the structure	
	Width	Height
686 x 1981	1390	2050
762 x 1981	1545	2050
838 x 1981	1695	2050
726 x 2040	1470	2110
826 x 2040	1670	2110
926 x 2040	1870	2110

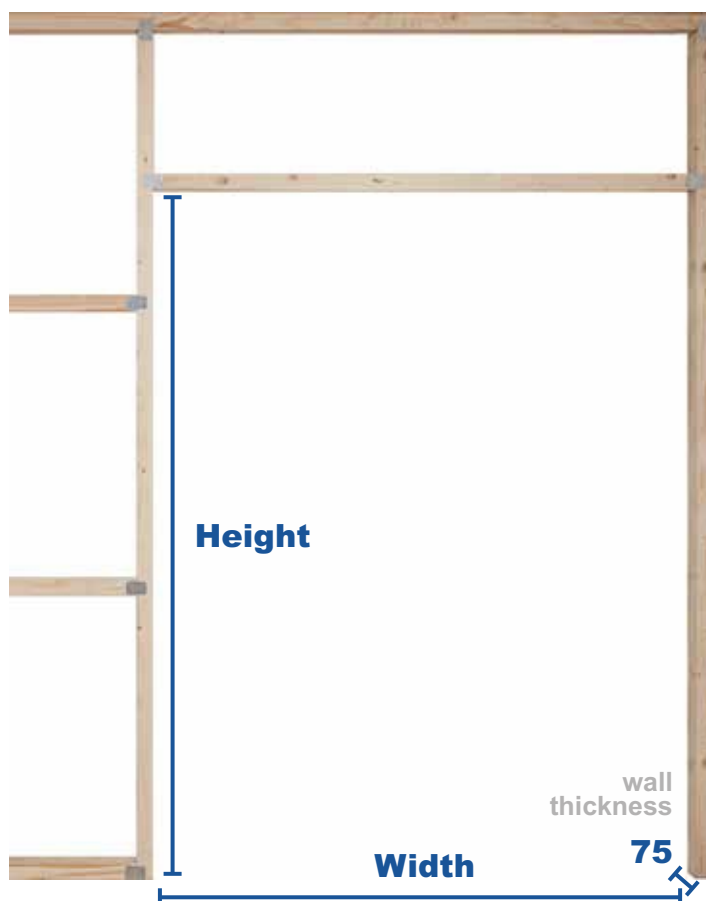

CHOOSE THE DOOR GUIDE

Door
Thickness



= 35 mm

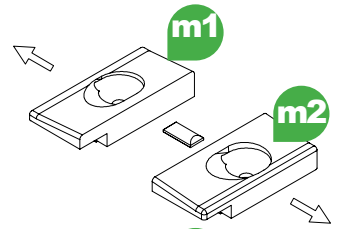
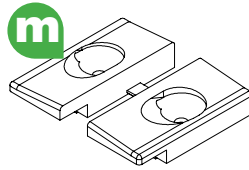

= 44 mm

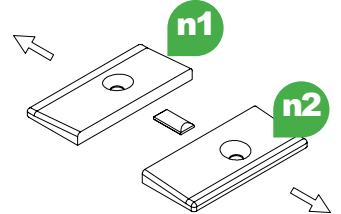
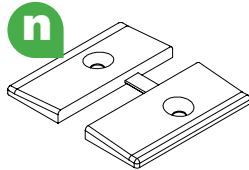

FOR EXAMPLE 44 MM THICK DOOR

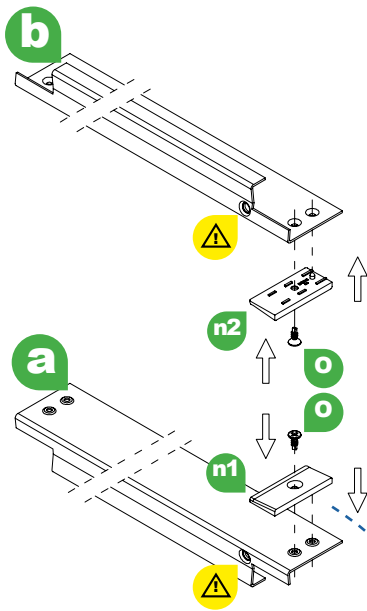

Use the end of
the vertical that
has this hole

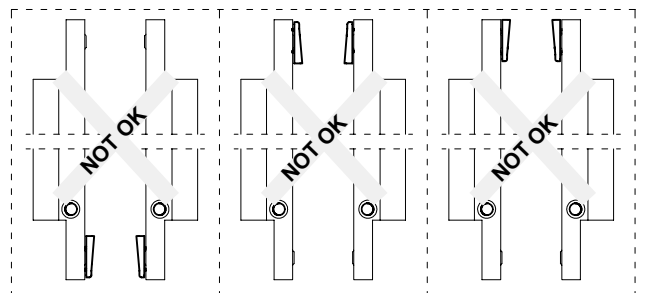
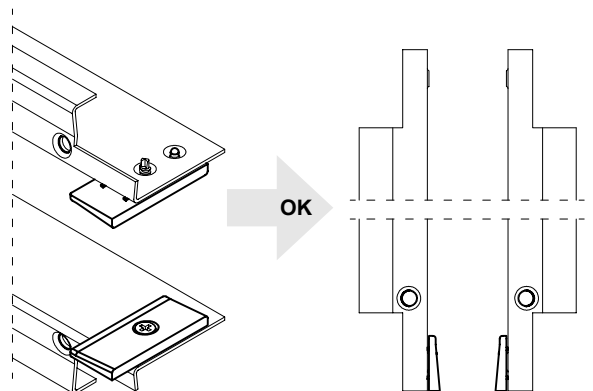

ATTACH BRACKETS

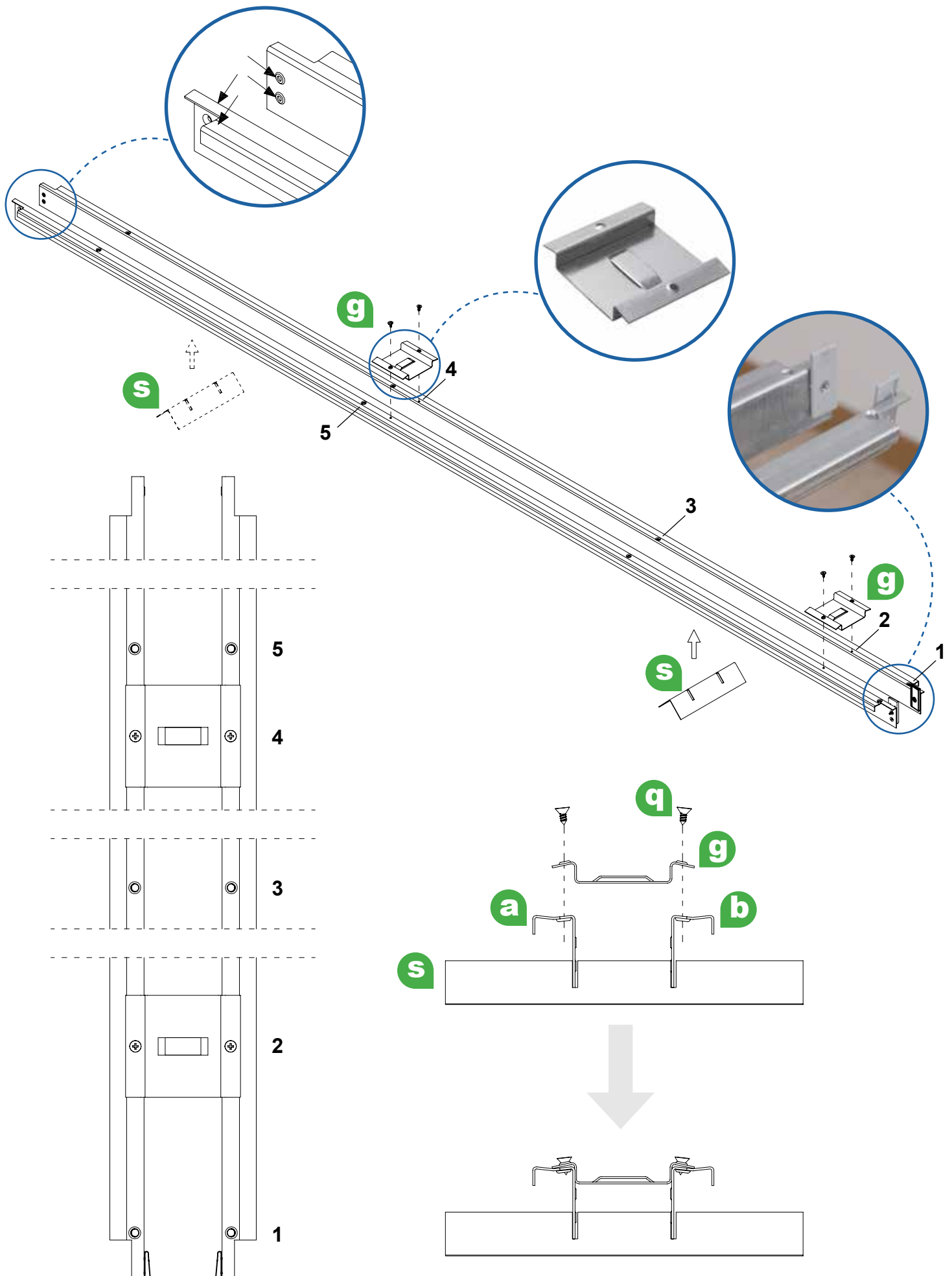

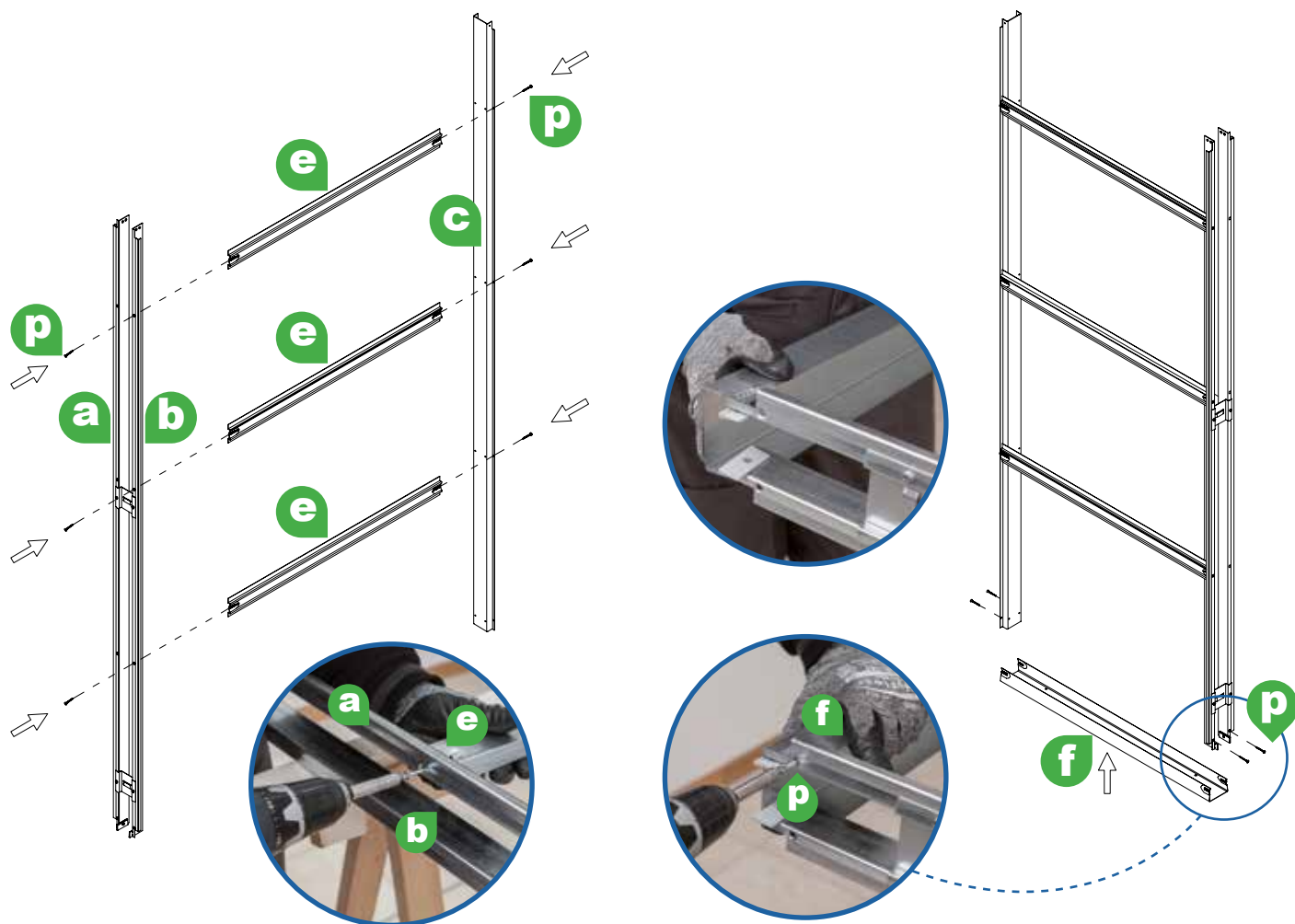

ASSEMBLE FRAME

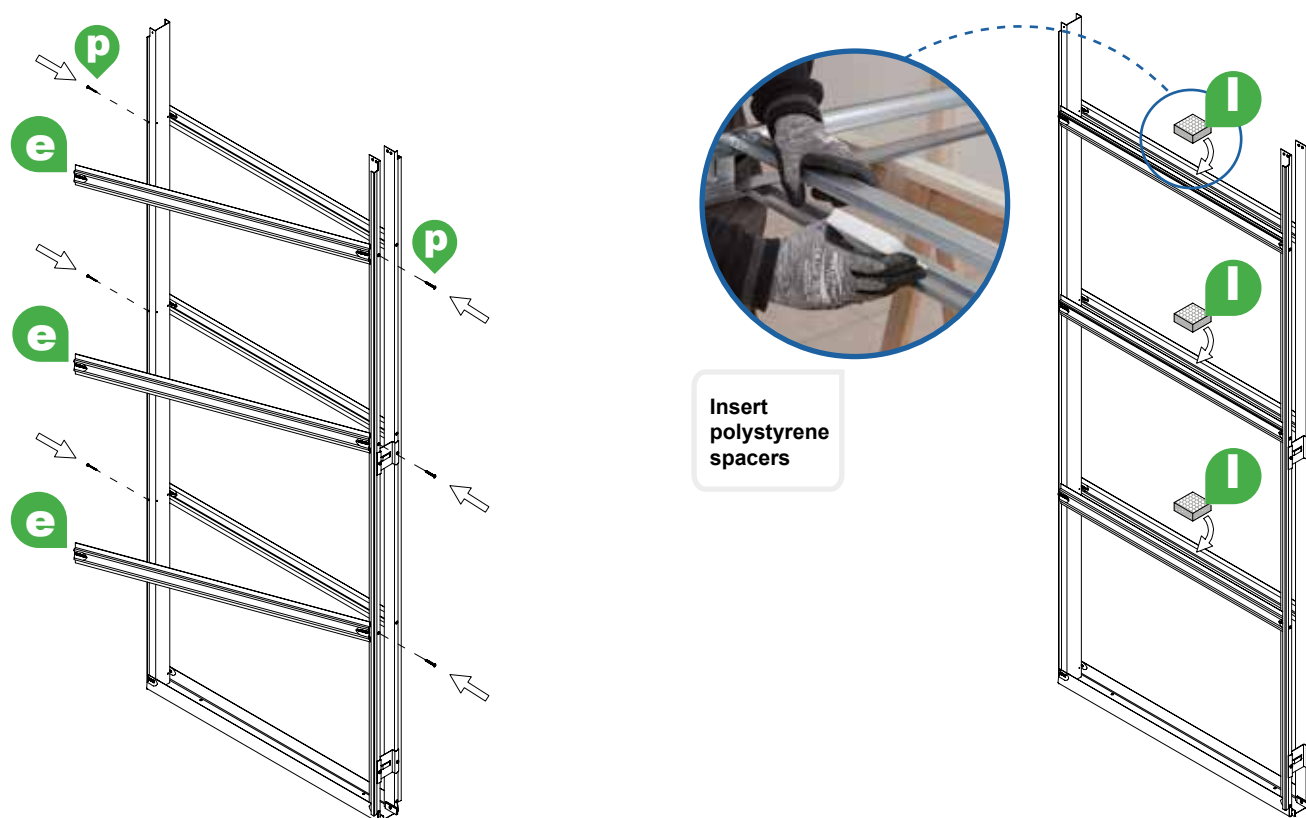

Assemble top brackets **h** and **i** on one side only for the moment. Note the brackets are different so position correctly.

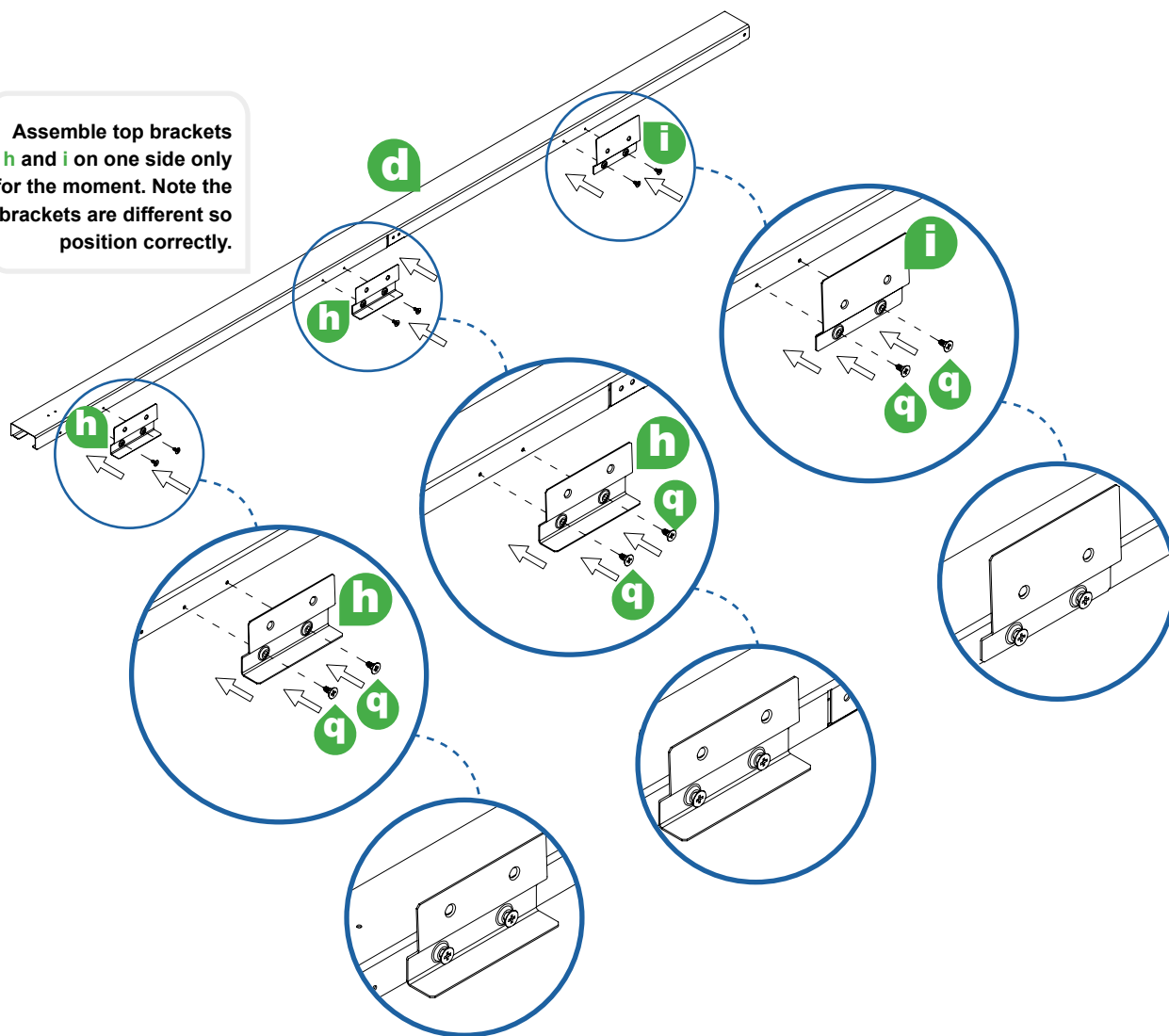

FINAL ASSEMBLY

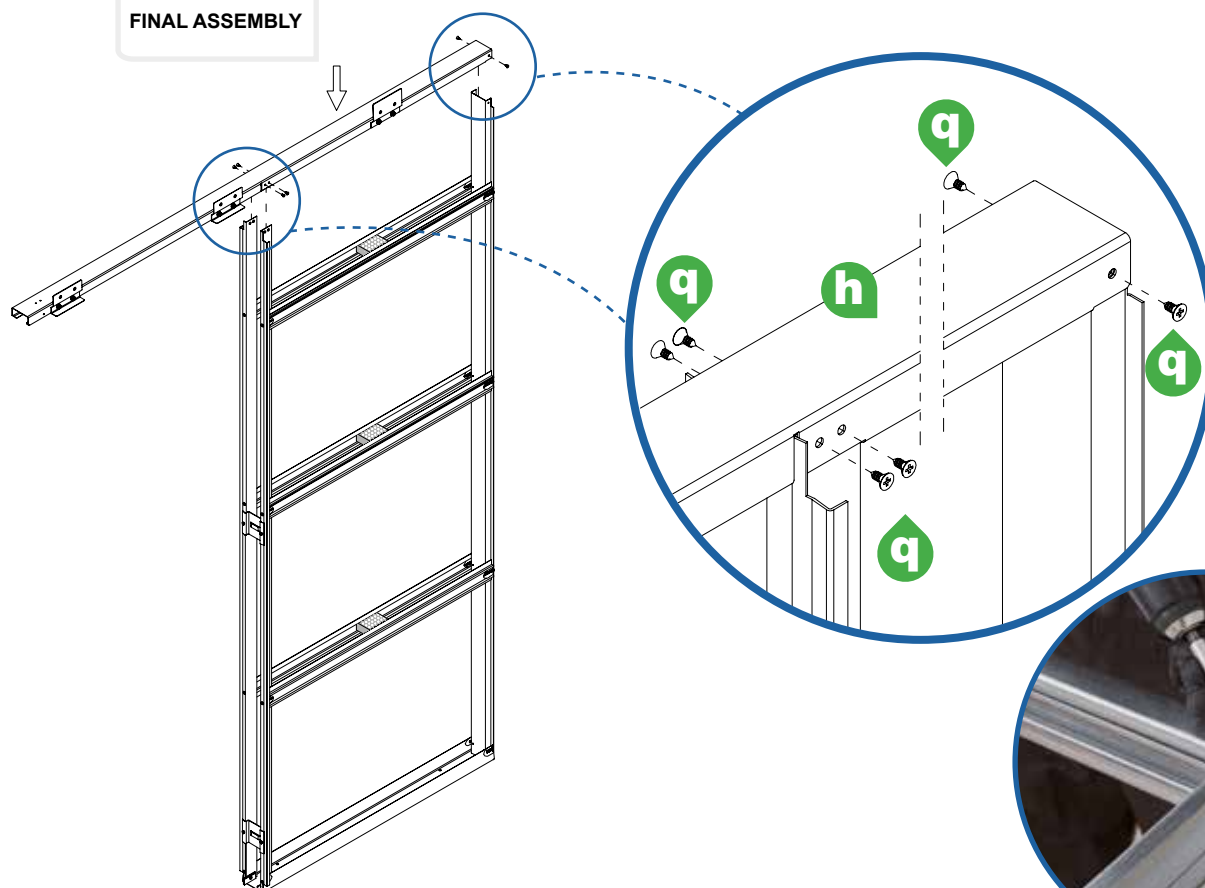

INSTALL INTO STUD WORK

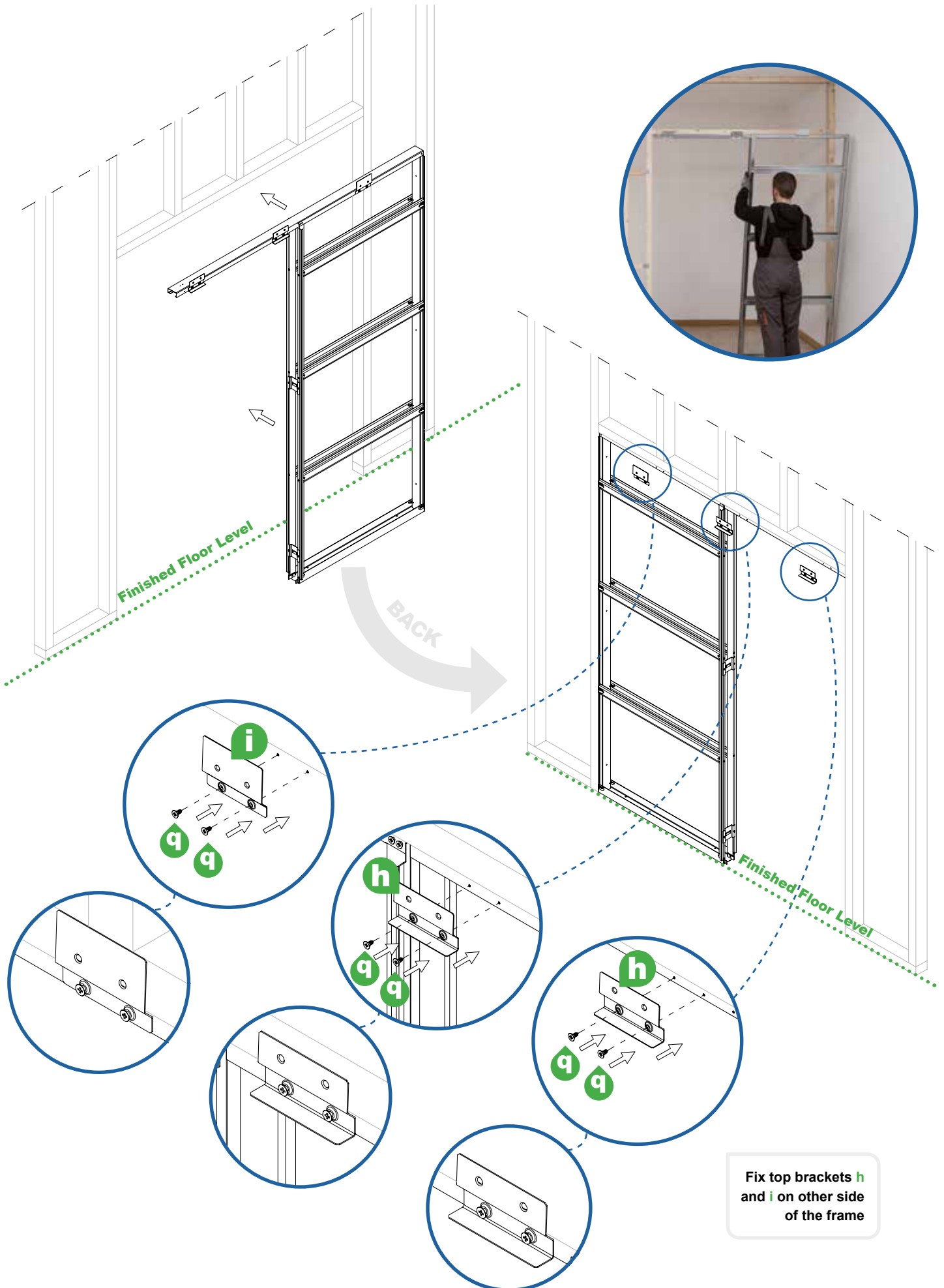

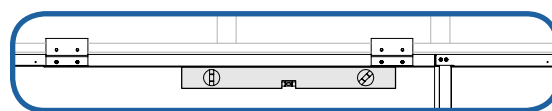
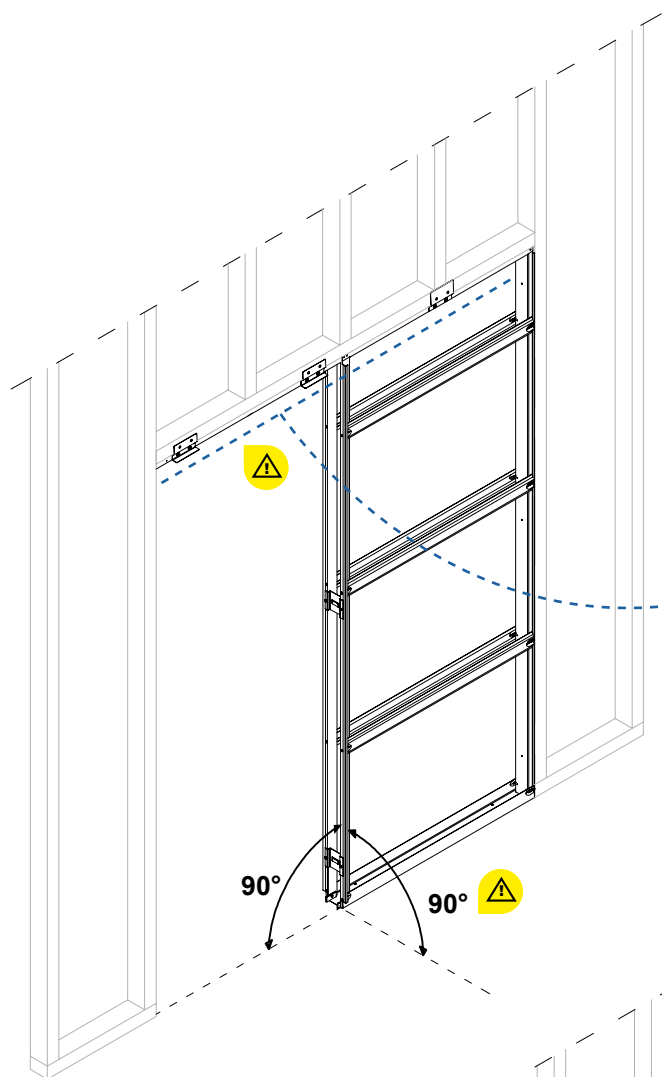

Ensure frame is
level and plumb

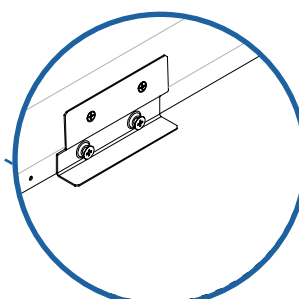
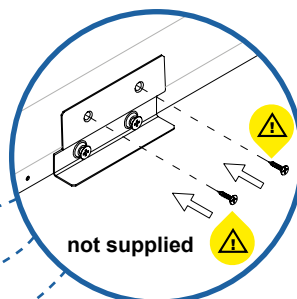
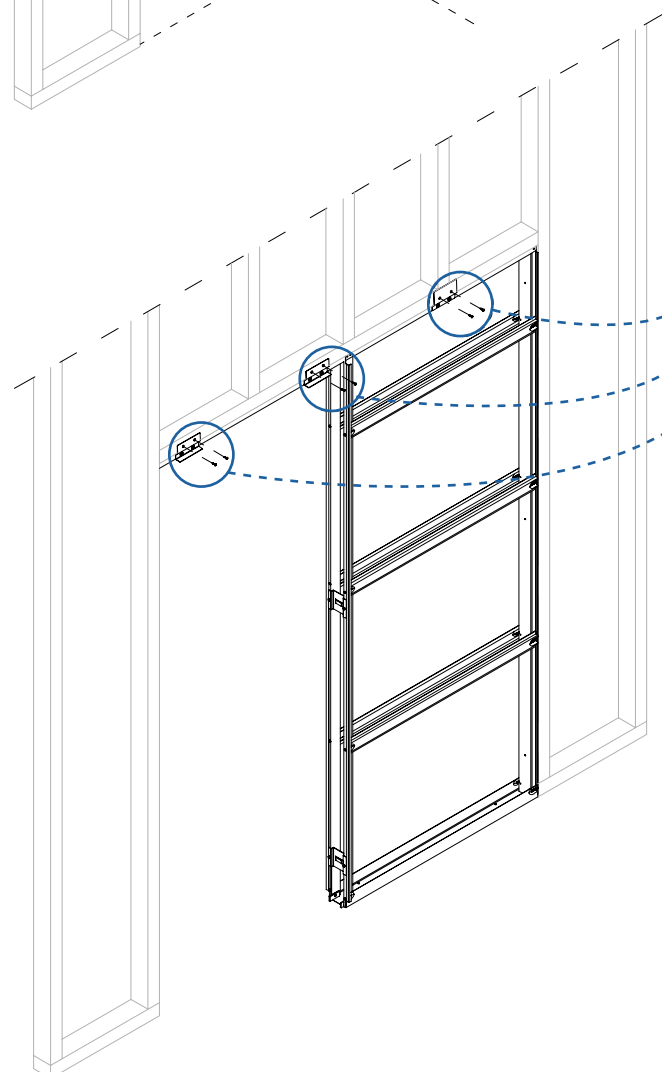

Screw brackets
to one side of
studwork

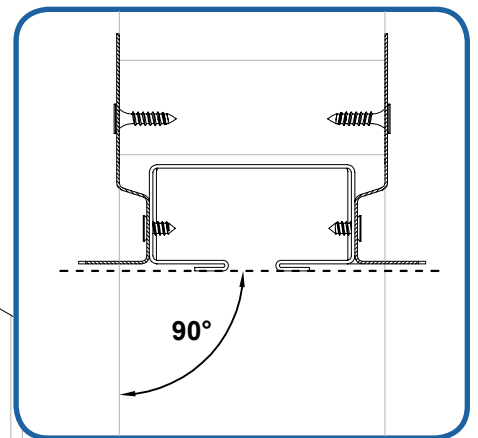
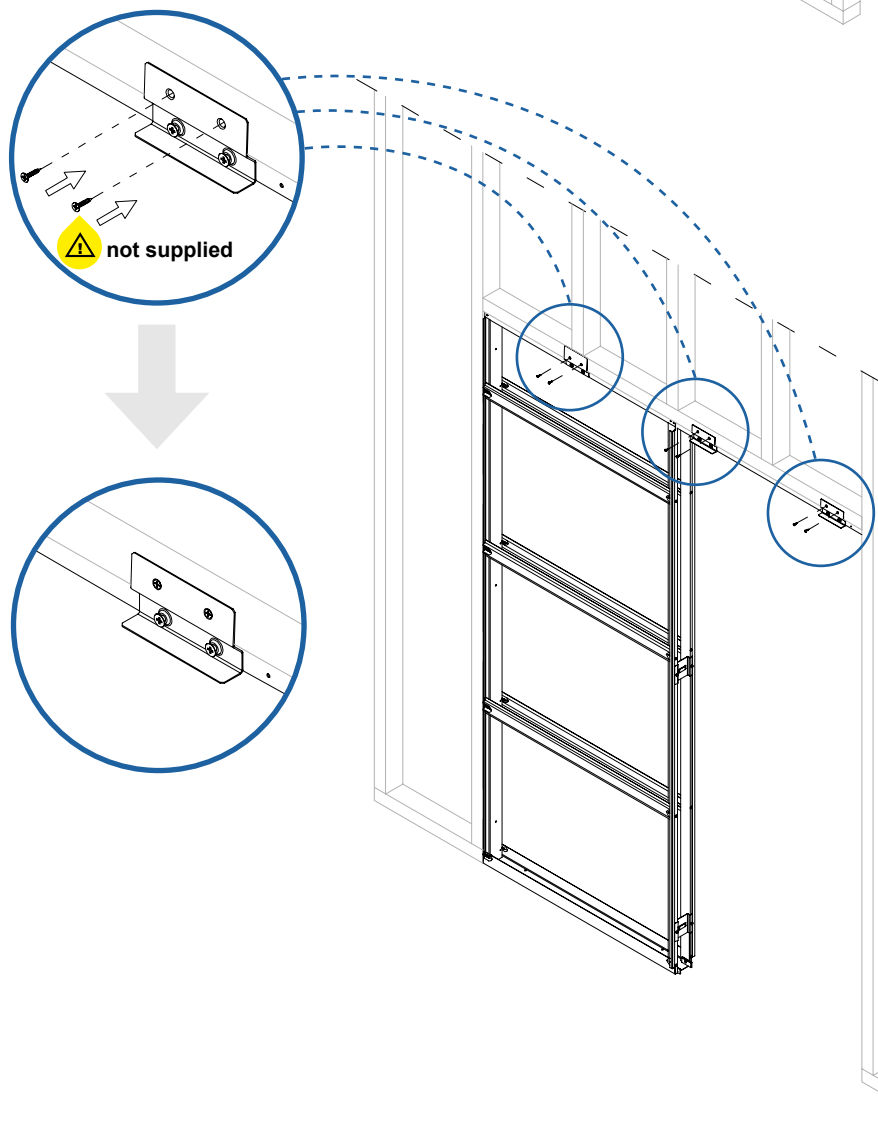
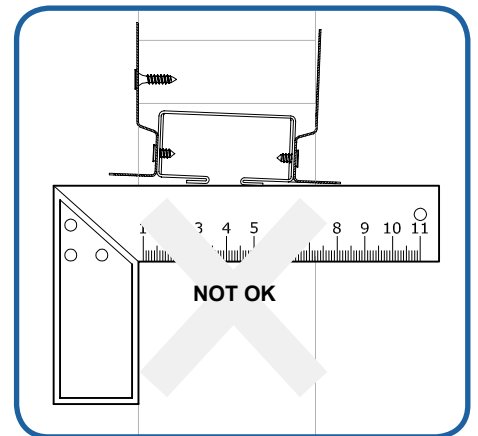
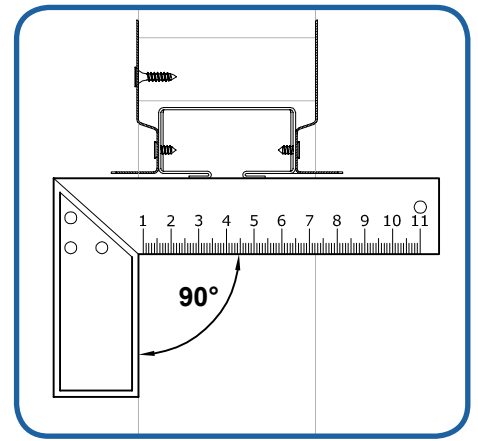

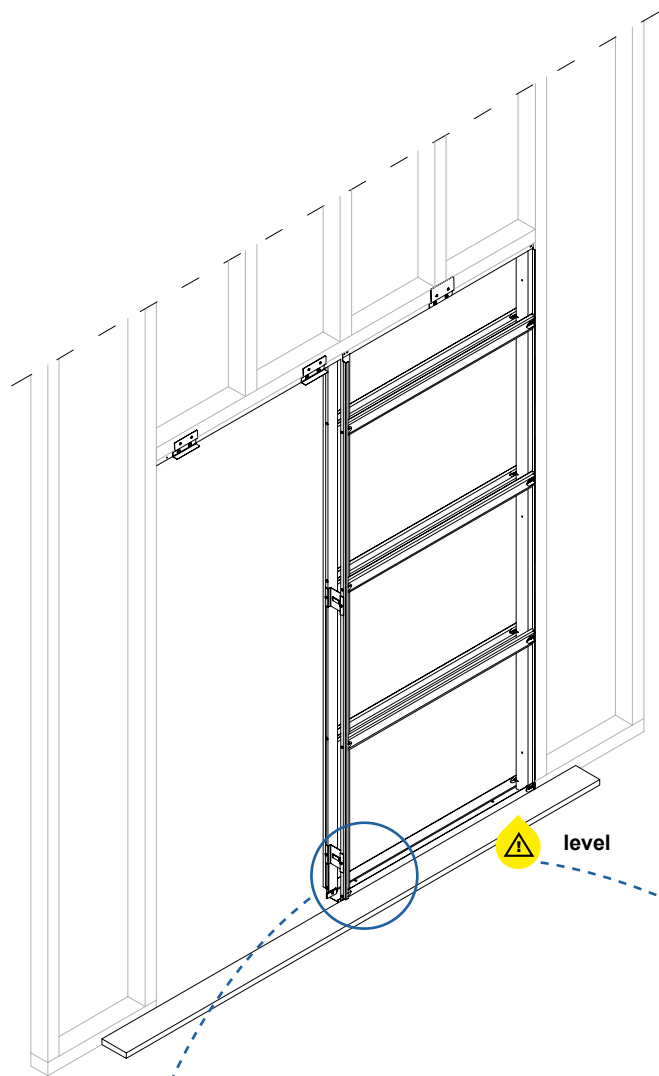

Place a straight edge
along the bottom of the
frame and ensure it is
inline with the stud work

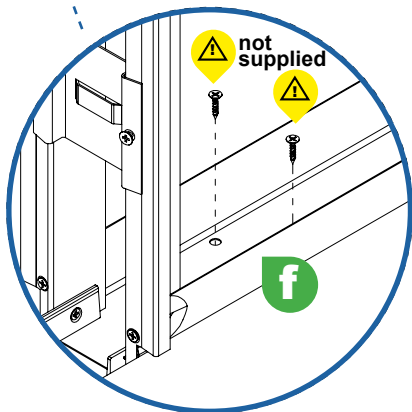
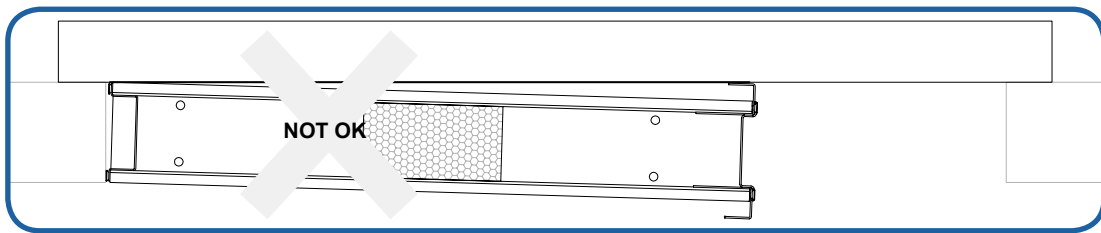
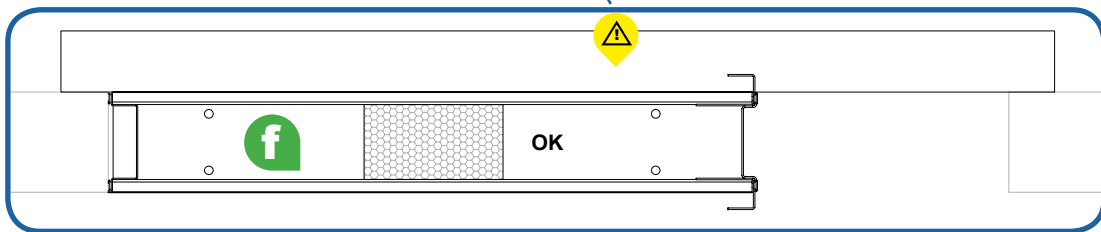

Screw the U section
f to the floor

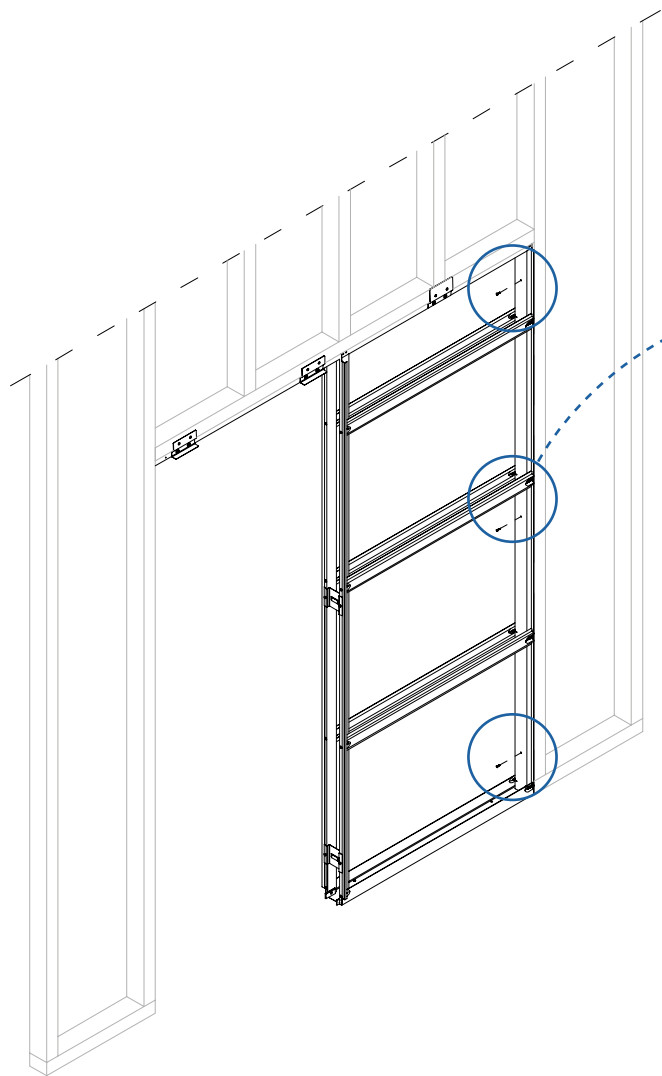

Screw pocket rear
vertical to studwork
securely



x2

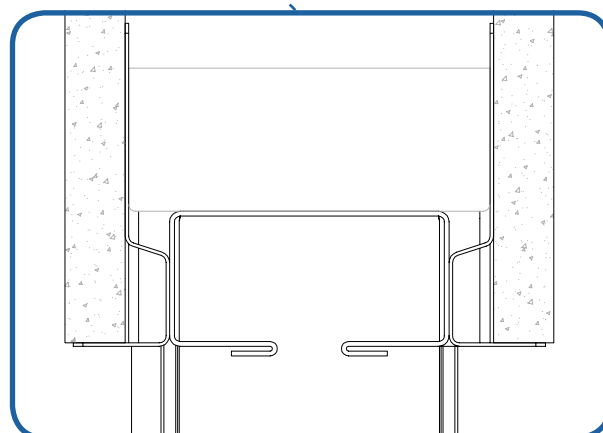

CAREFULLY
CLEAN THE
TRACK TWICE

ATTACHING THE PLASTERBOARD

USE 12.5 MM
PLASTERBOARD

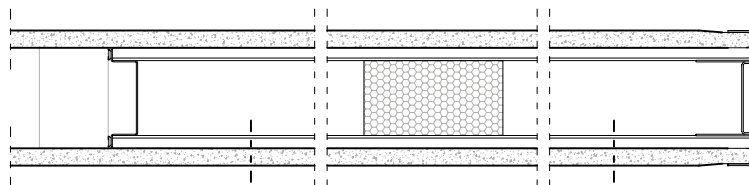
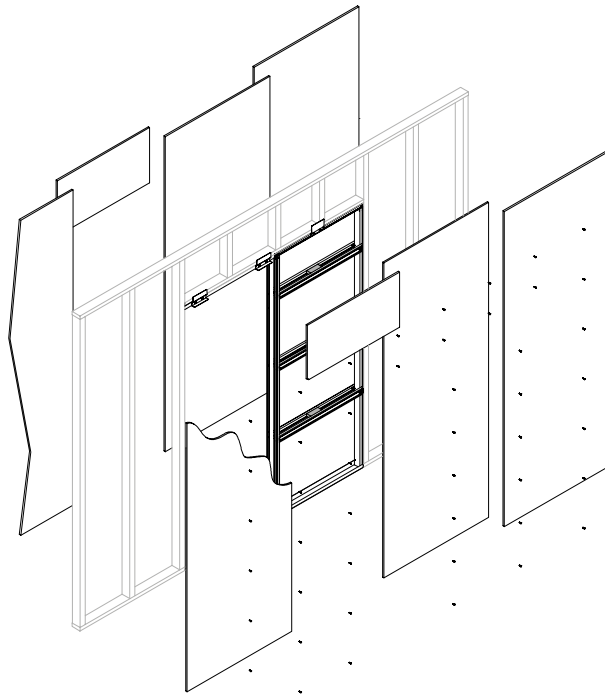

Ø 2



Drill through
the board and
horizontal bars

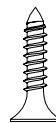
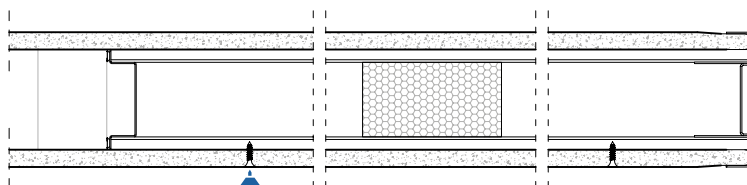

Use supplied
19 mm screws

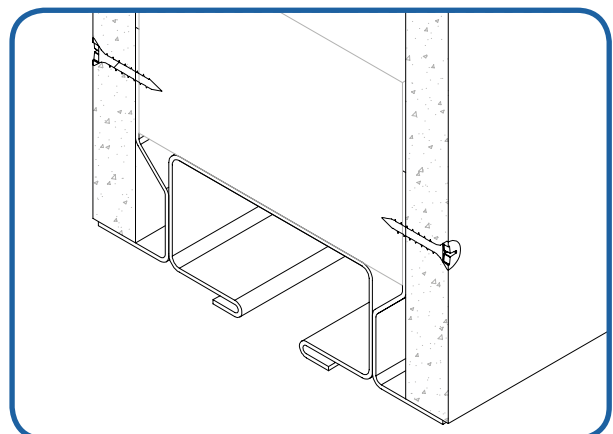
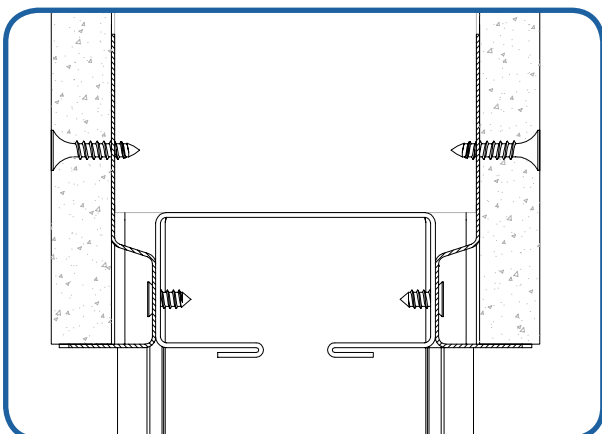

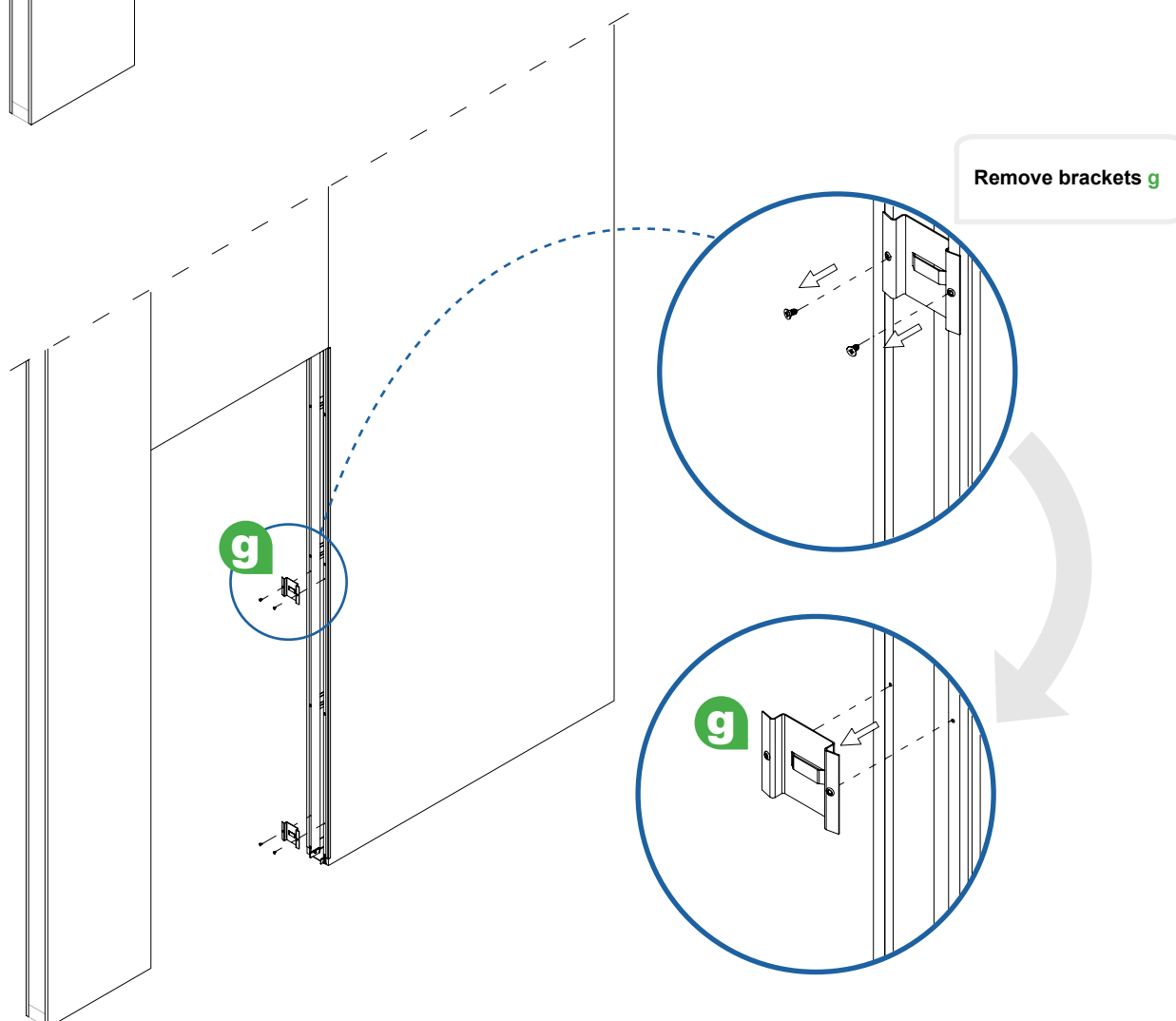
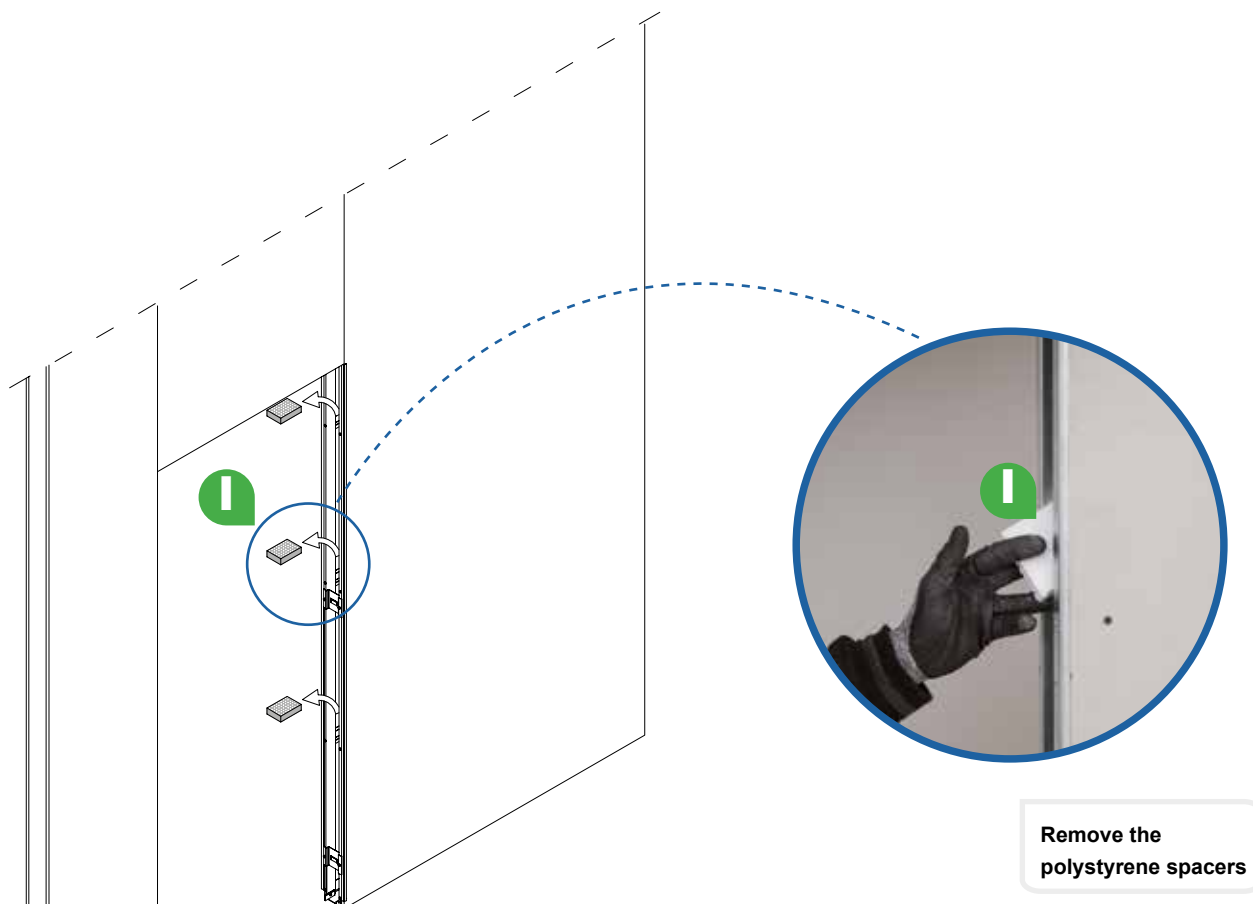

ASSEMBLE RUNNERS

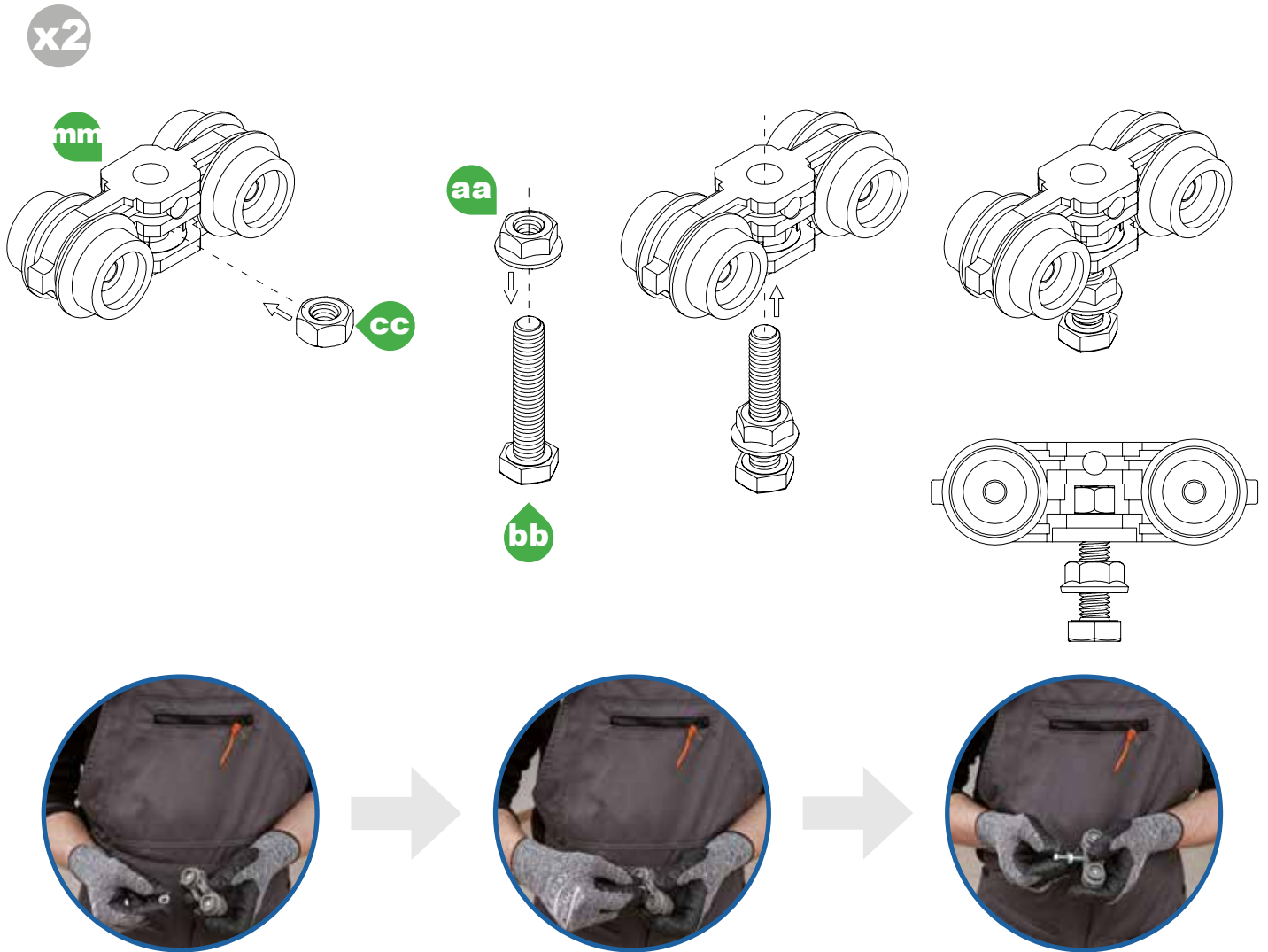

FEED RUNNERS INTO TRUCK

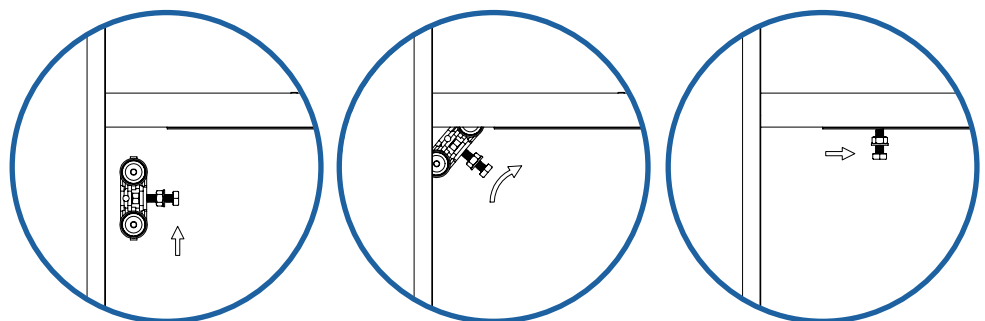

INSTALL DOOR BRACKETS

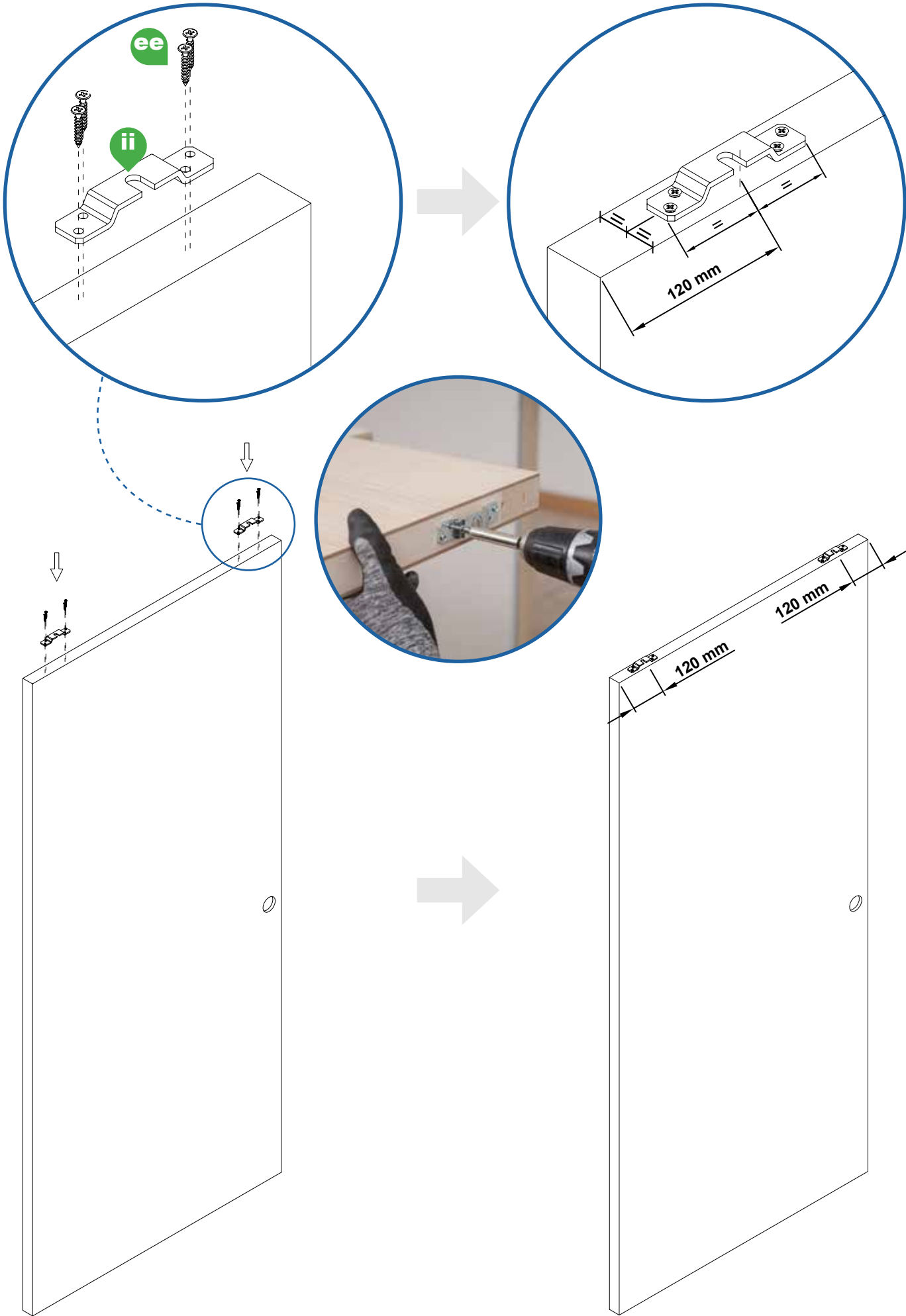

INSTALL REAR DOOR BUMPER

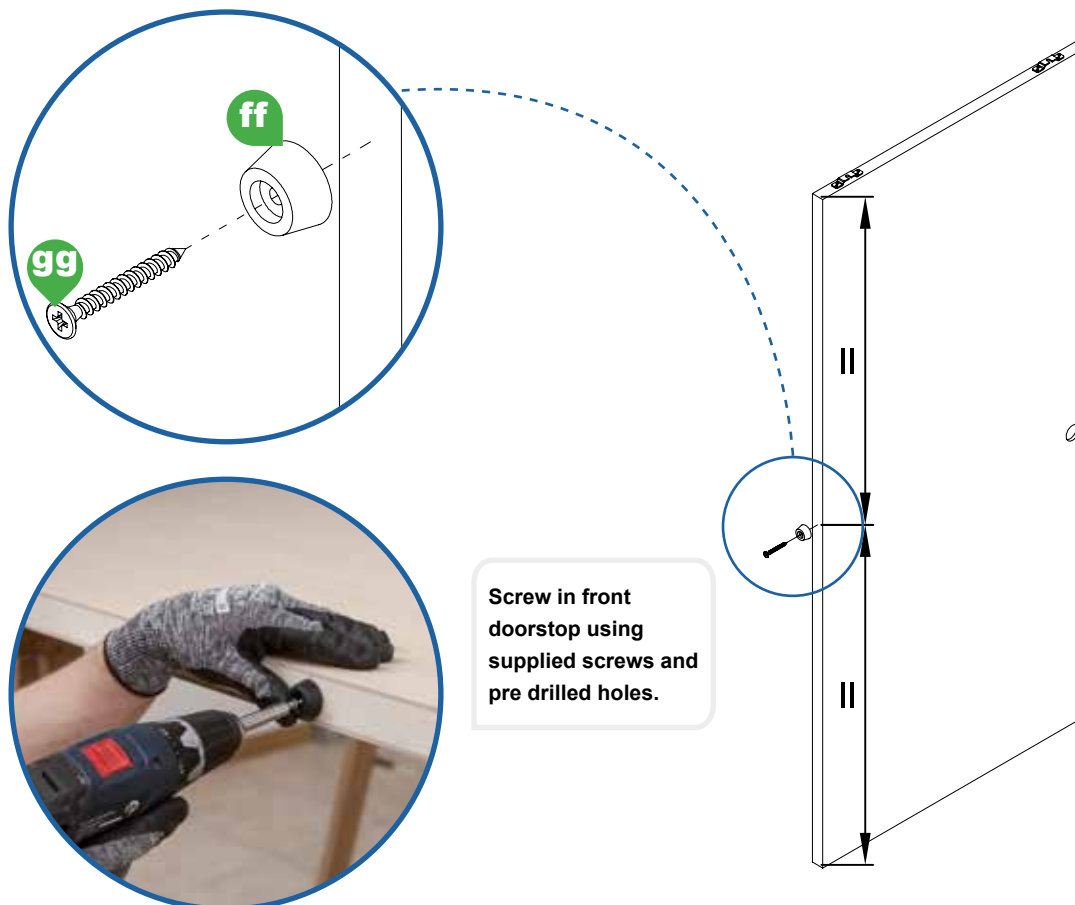

INSTALL DOOR PANEL

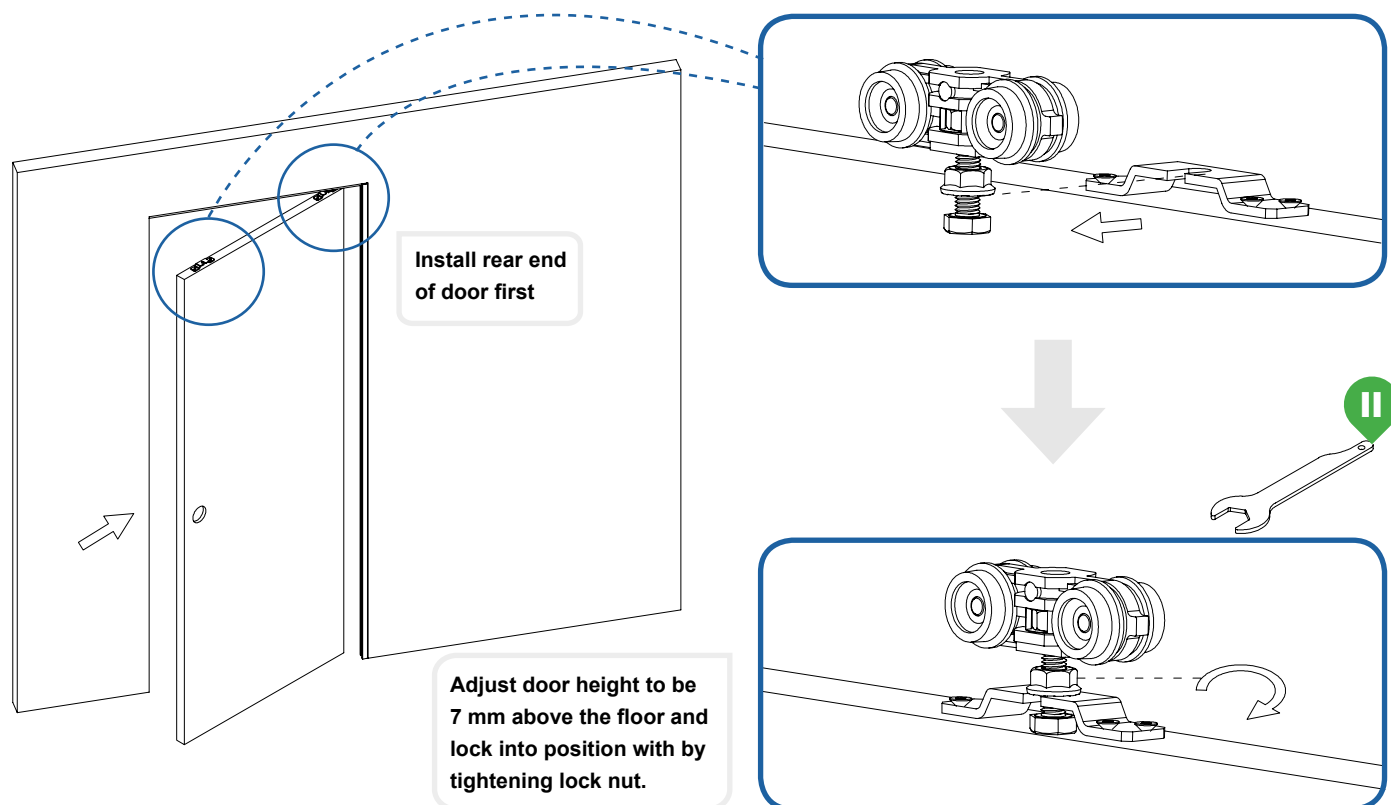

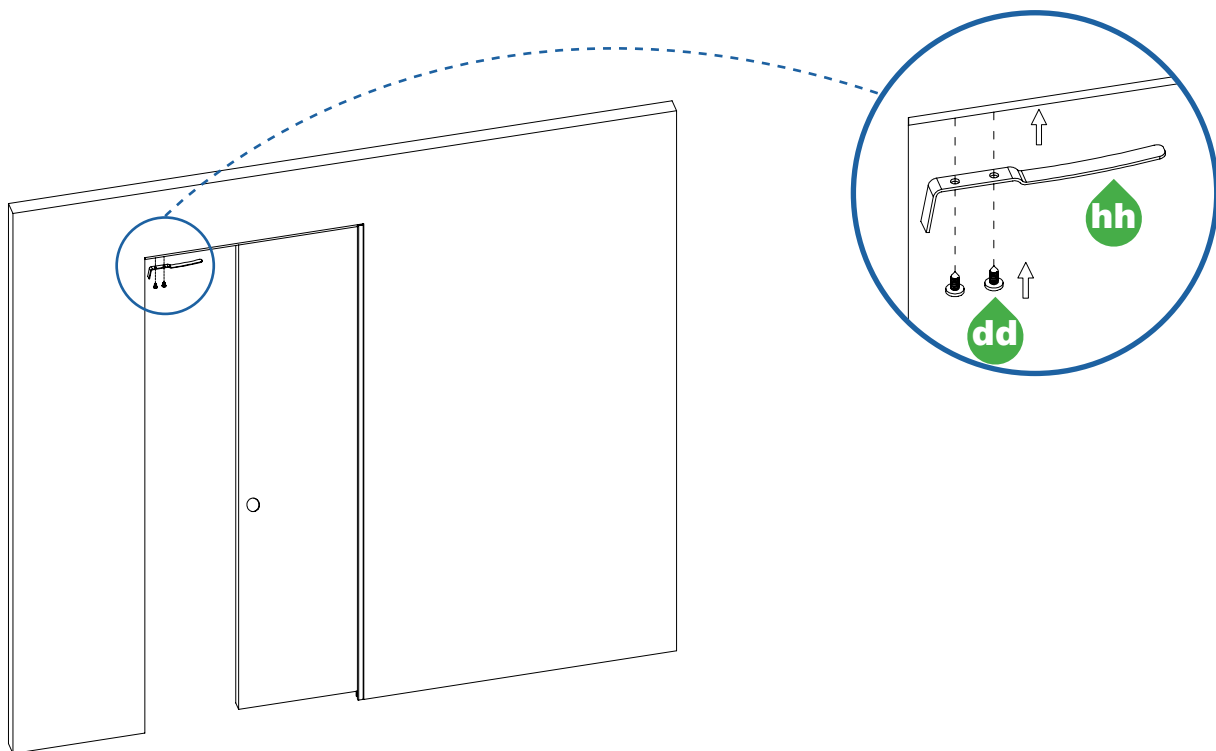

screw in front doorstep
using supplied screws
and pre drilled holes

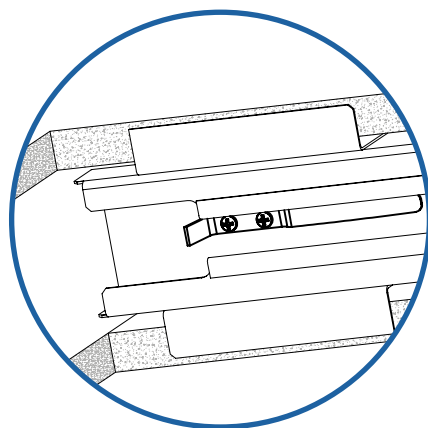
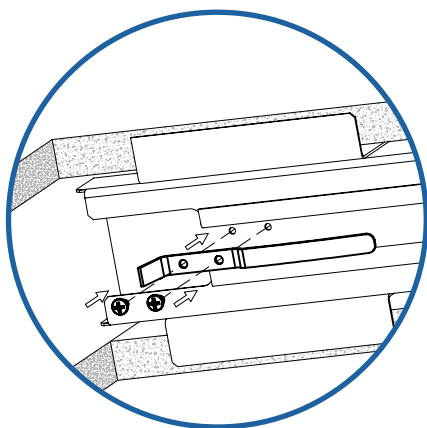

ARCHITRAVES

**WE DO NOT SUPPLY ARCHITRAVES AS THE CHOICE IS AN INDIVIDUAL ONE
HOWEVER HERE ARE TWO SUGGESTIONS FOR YOU**



= 35 mm

= 44 mm

For flat architraves
you can use a right
angle profile. Please
note min architrave
length

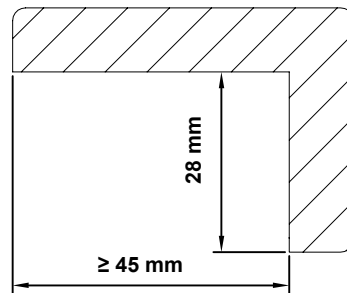

1

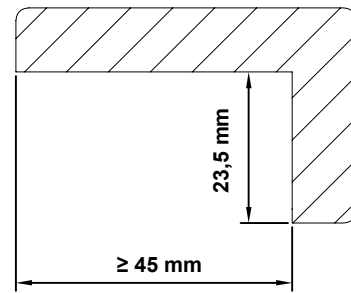

Use a flat timber for
the internal liner and
you chosen architrave
on the external
surface. Please note
min architrave length.

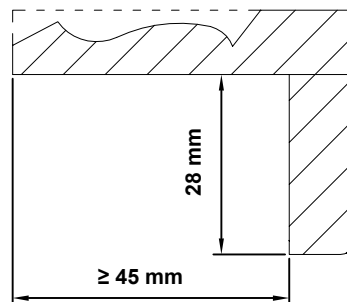

2

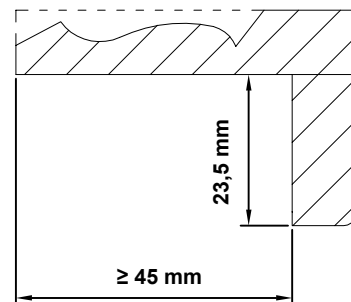

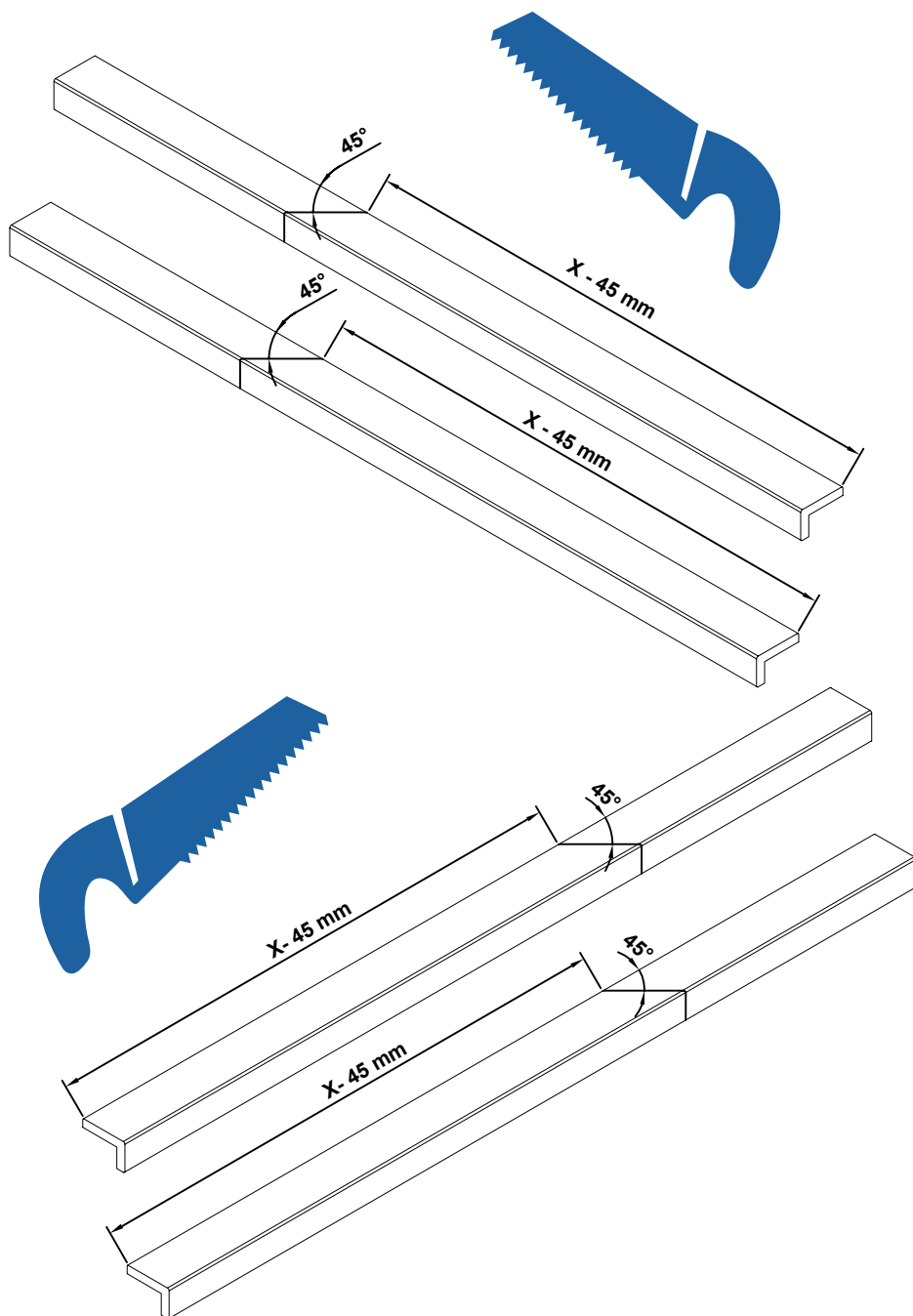
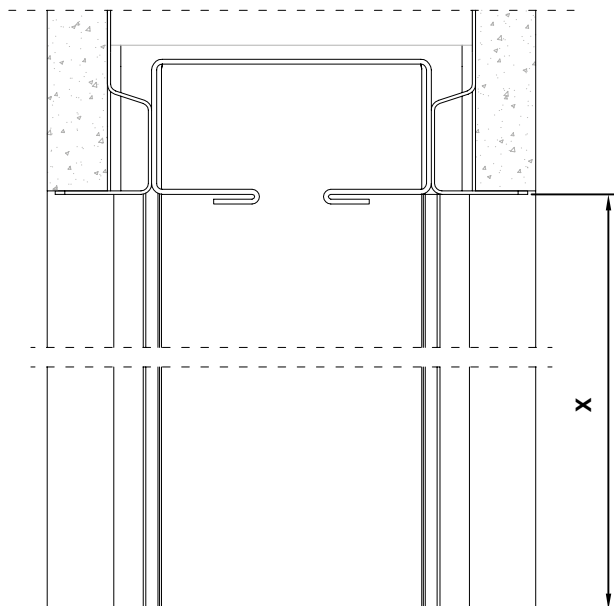
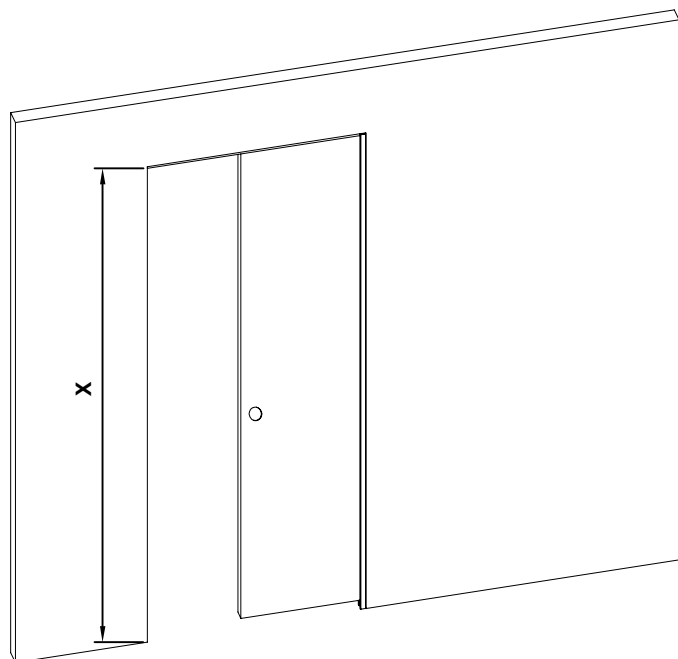

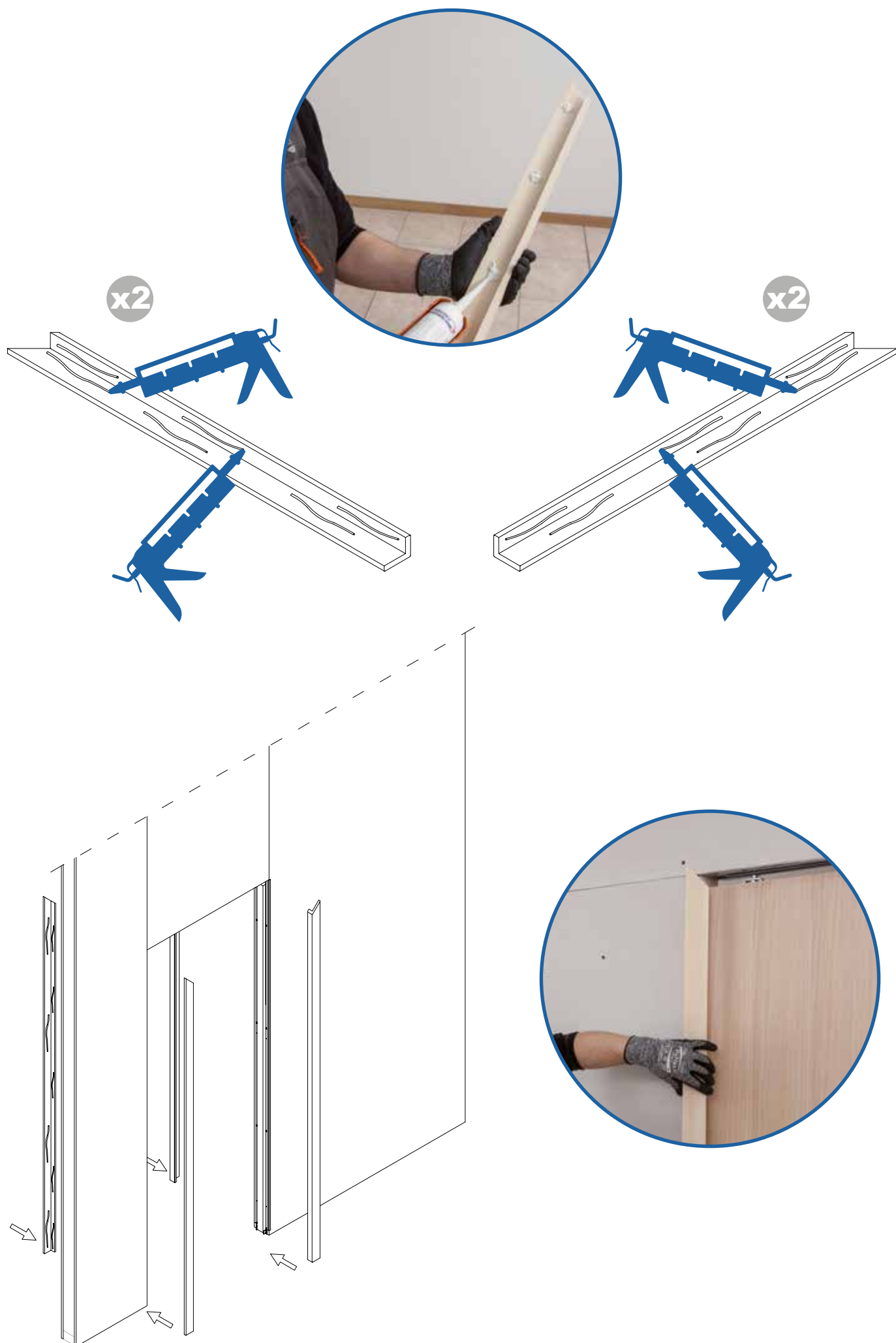

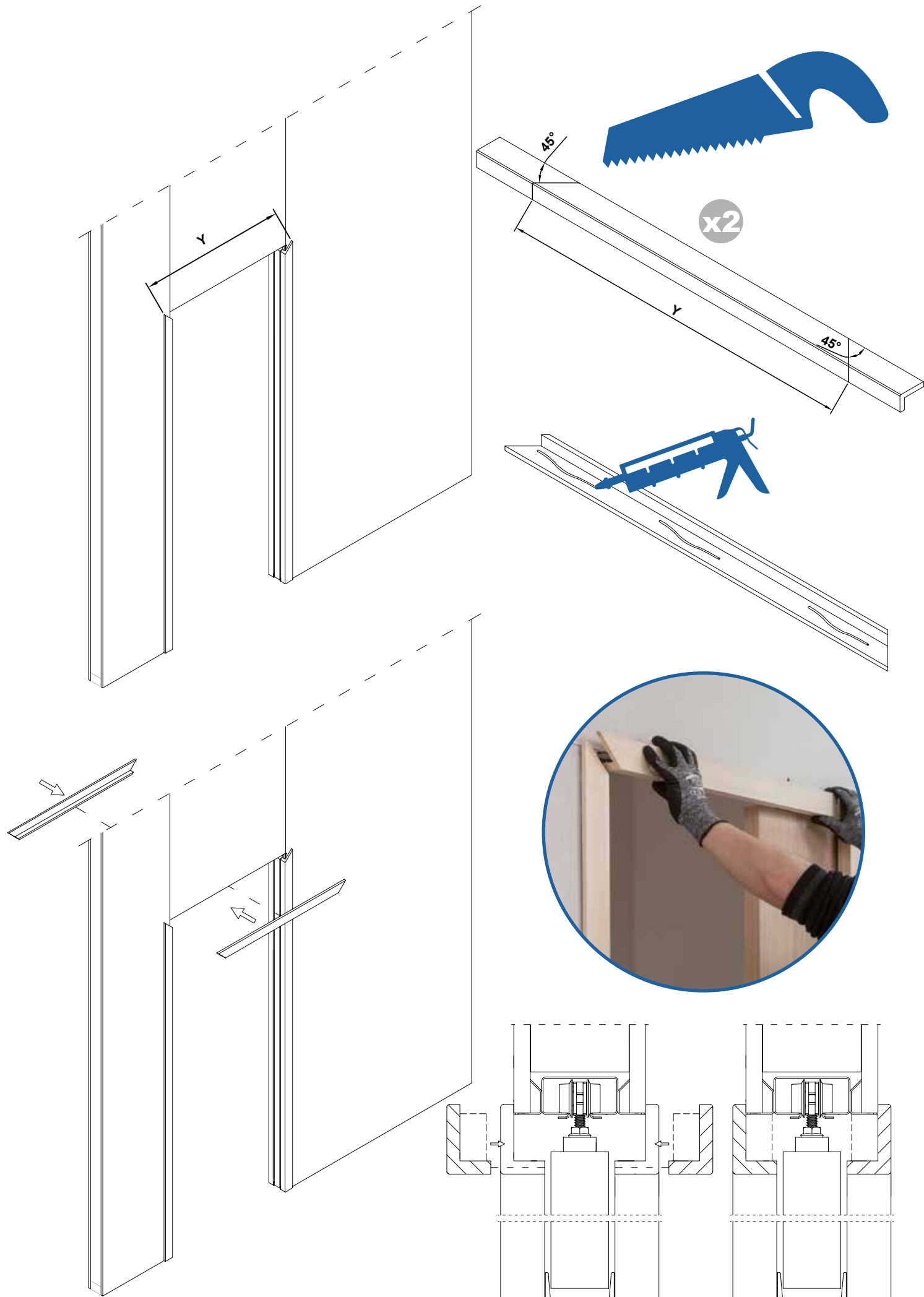

NEEDS HELP?

CALL - 0113 245 8157

SPACE**SAVING****DOORS.CO.UK**

